



**TAIJAAN**

# PRODUCT CATALOGUE

## TAI JAAN PLASTIC (VIETNAM) LIMITED LIABILITY COMPANY

Address: Road D9 – My Phuoc Industrial Park –  
Ben Cat Town – Binh Duong Province – Viet Nam



**ISO 9001: 2015**



## ABOUT US

- **Company name:** TAI JAAN PLASTIC (VIETNAM) LIMITED LIABILITY COMPANY
- **Abbreviated name:** TAI JAAN PLASTIC (VIETNAM) CO, LTD / TAI JAAN



- **Incorporation date:** 15 June 2004
- **Head office:** Lot M-1A-CN, Road D9, My Phuoc Industrial Park, Thoi Hoa Ward, Ben Cat Town, Binh Duong Province, Viet Nam
- **Website:** taijaanplastic-vn.com
- **Hotline:** (+84) 274.3567.222/223/224
- **Email:** taijaan.plastic@gmail.com

Incorporated since 15th June 2004 and specialized in manufacturing various premium plastic valves, fittings and materials for water supply and drainage industry, Tai Jaan Plastic (Vietnam) Co., Ltd's coverage is widely recognized by its domestic and foreign premium offerings.

In order to successfully integrate with the world economy development and to meet the high competitiveness of products on the market, TAI JAAN's priority is highlighted by investment into advanced equipment, professional production management and skillful technical staff. Its nationwide and worldwide distribution channel system, guaranteed delivery schedule, and reasonable price are offered to meet the customers' highest satisfaction.

Strength makes TAI JAAN trademark difference, including: specialization in each department, high responsibility to create the perfect products in each detail. Furthermore, the departments are willing to exchange job and share difficulties and initiatives to develop a more dynamic, creative and professional TAI JAAN in each product as well as after-sales services.

With the motto "**Dedication - Renovation - Quality - Responsibility**" and the orientation of continuous improvement to develop, TAI JAAN has been making great efforts to improve human resources and material resources, build brand reputation and great trust in each product we provide to further satisfy the increasing demands of the customers.

**It is our honor to serve you!**





# BUSINESS SCALE AND MARKET

Tai Jaan head office is located in Binh Duong Province, characterized by 25,500 m<sup>2</sup> office and plant, equipped with modern machines and equipment system, specialized in producing various premium plastic valves, accessories of water supply and drainage industry with top quality. Its Northern Branch is situated in Hung Yen City. Its footprint is recorded by over 1000 agents and distributors, covering 63/63 provinces and cities in Vietnam.

With the vision of far development, Tai Jaan always strives to improve and increase the quality of each product not only to meet the domestic demands but also access to the international markets.

Currently, Tai Jaan products are available and trusted by myriad of demanding markets such as Japan, Taiwan and Indonesia, etc.

**Tai Jaan product - Unlock flow, connect prosperity!**





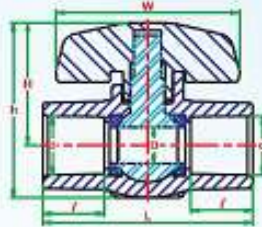

## I. PVC BALL VALVE – ORANGE HANDLE (AB)

CODE	SPECIFICATIONS						
	SIZE	D	l	L	h	H	W
AB1104	Ø 21 - (1/2")	15	23.5	80	65	45	70
AB1106	Ø 27 - (3/4")	20	26.5	90	74	51	80
AB1110	Ø 34 - (1")	25	30.5	105	85	57	93.5
AB1112	Ø 42 - (1 1/4")	32	32.5	119	101	68	103
AB1115	Ø 49 - (1 1/2")	39	39	138	114	76	118.5
AB1120	Ø 60 - (2")	48	42.5	158	139.5	87	139

### Guide:

- 1.1 - Used for civil living and irrigation system.
- 1.2 - Avoid installing in high temperature locations. (Allowable temperature of 0° - 60°C).
- 1.3 - Avoid sticking the glue on valve ball.

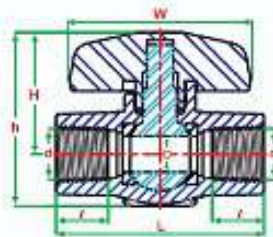

## II. FEMALE THREADED PVC BALL VALVE – ORANGE HANDLE (AB-R)

CODE	SPECIFICATIONS						
	SIZE	D	l	L	h	H	W
AB1104-R	Ø 21 - (1/2")	15	23.5	80	65	45	70
AB1106-R	Ø 27 - (3/4")	20	26.5	90	74	51	80
AB1110-R	Ø 34 - (1")	25	30.5	105	85	57	93.5
AB1112-R	Ø 42 - (1 1/4")	32	32.5	119	101	68	103
AB1115-R	Ø 49 - (1 1/2")	39	39	138	114	76	118.5
AB1120-R	Ø 60 - (2")	48	42.5	158	139.5	87	139

### Guide:

- 1.1 - Used for civil living and irrigation system.
- 1.2 - Avoid installing in high temperature locations. (Allowable temperature of 0° - 60°C).
- 1.3 - Avoid sticking the glue on valve ball.

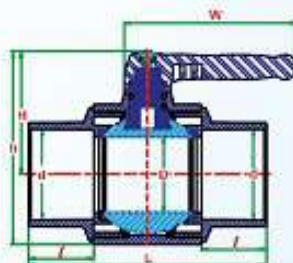

## III. PVC BALL VALVE – BIG SIZE, ORANGE HANDLE (AGB)

CODE	SPECIFICATIONS						
	SIZE	D	l	L	h	H	W
AGB1125	Ø76 2' 1/2"	65	76	236	190	120	190
AGB1130	Ø90 3"	80	66	298	204	131	190
AGB1140	Ø114 4"	100					
AGB1150	Ø140 5"	100					

### Guide:

- 1.1 - Used for civil living and irrigation system.
- 1.2 - Avoid installing in high temperature locations. (Allowable temperature of 0° - 60°C).
- 1.3 - Avoid sticking the glue on valve ball.



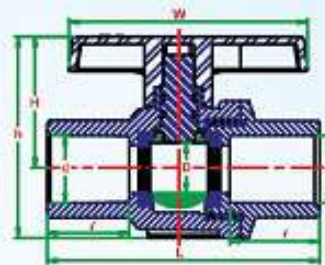

#### IV. PVC BALL VALVE - WHITE HANDLE (AF)

CODE	SPECIFICATIONS						
	SIZE	D	L	L	h	H	W
AF1104	Ø 21 - (1/2")	15	26	86	65	44	76
AF1106	Ø 27 - (3/4")	20	32	99	75	48	86
AF1110	Ø 34 - (1")	25	35	114	90	60	99
AF1112	Ø 42 - (1 1/4")	32	38	131	105	64	114.5
AF1115	Ø 49 - (1 1/2")	40	44	152	115.5	73	133
AF1120	Ø 60 - (2")	50	45	166	133	82	147.5

#### Guide:

- 1.1 - Used for civil living and irrigation system.
- 1.2 - Avoid installing in high temperature locations.  
(Allowable temperature of 0° - 60°C).
- 1.3 - Avoid sticking the glue on valve ball.

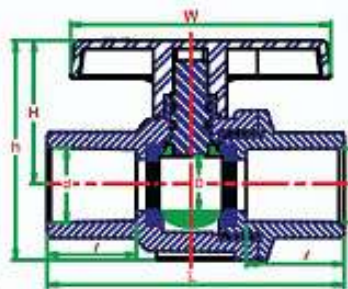

#### V. PVC BALL VALVE - RED HANDLE (AG)

CODE	SPECIFICATIONS						
	SIZE	D	L	L	h	H	W
AG1104	Ø 21 - (1/2")	15	26	86	65	44	76
AG1106	Ø 27 - (3/4")	20	32	99	75	48	86
AG1110	Ø 34 - (1")	25	35	114	90	60	99
AG1112	Ø 42 - (1 1/4")	32	38	131	105	64	114.5
AG1115	Ø 49 - (1 1/2")	40	44	152	115.5	73	133
AG1120	Ø 60 - (2")	50	45	166	133	82	147.5

#### Guide:

- 1.1 - Used for civil living and irrigation system.
- 1.2 - Avoid installing in high temperature locations.  
(Allowable temperature of 0° - 60°C).
- 1.3 - Avoid sticking the glue on valve ball.

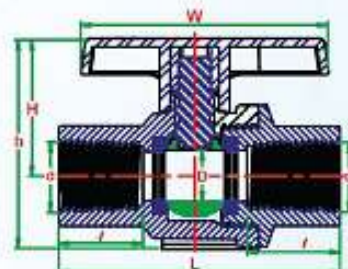

#### VI. FEMALE THREADED PVC BALL VALVE - RED HANDLE (AG-R)

CODE	SPECIFICATIONS						
	SIZE	D	L	L	h	H	W
AG1104-R	Ø 21 - (1/2")	15	26	86	65	44	76
AG1106-R	Ø 27 - (3/4")	20	32	99	75	48	86
AG1110-R	Ø 34 - (1")	25	35	114	90	60	99
AG1112-R	Ø 42 - (1 1/4")	32	38	131	105	64	114.5
AG1115-R	Ø 49 - (1 1/2")	40	44	152	115.5	73	133
AG1120-R	Ø 60 - (2")	50	45	166	133	82	147.5

#### Guide:

- 1.1 - Used for civil living and irrigation system.
- 1.2 - Avoid installing in high temperature locations.  
(Allowable temperature of 0° - 60°C).
- 1.3 - Avoid sticking the glue on valve ball.

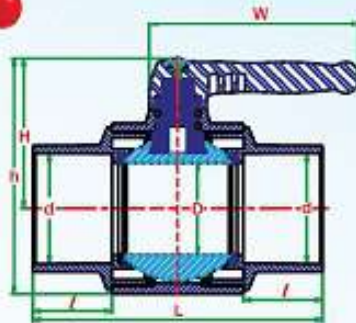

## VII. PVC BALL VALVE – BIG SIZE, RED HANDLE (AG)

CODE	SPECIFICATIONS						
	SIZE	D	f	L	h	H	W
AG1125	Ø 76 - (2.5")	65	58	210	180	115	190
AG1130	Ø 90 - (3")	75	72	255	200	125	190
AG1140	Ø 114 - (4")	95	82	300	245	150	215
AG1150	Ø 140 - (5")	95	92	325	245	150	215

### Guide:

- 1.1 - Used for civil living and irrigation system.
- 1.2 - Avoid installing in high temperature locations.  
(Allowable temperature of 0° - 60°C).
- 1.3 - Avoid sticking the glue on valve ball.

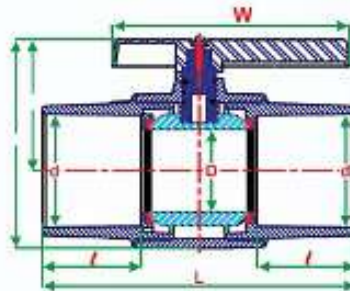

## VIII. 160/168MM PVC BALL VALVE – RED HANDLE

CODE	SPECIFICATIONS						
	SIZE	D	f	L	h	H	W
AG1160-BS	Ø168 (6")	125	148.5	472	316	200	356.5
AG1160-BN	Ø160 (6")	125	148.5	472	316	200	356.5

### Guide:

- 1.1 - Used for industrial systems and large sized pipes.
- 1.2 - Avoid installing in high temperature locations.  
(Allowable temperature of 0° - 60°C).
- 1.3 - Avoid sticking the glue on valve ball.

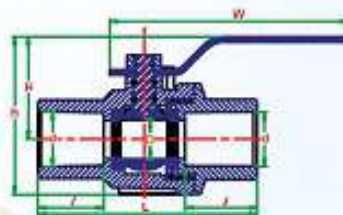

## IX. PVC BALL VALVE – INOX HANDLE, PLASTIC BALL (BF)

CODE	SPECIFICATIONS						
	SIZE	D	f	L	h	H	W
BF2104	Ø 21 - (1/2")	15	26	86	64.5	41	94
BF2106	Ø 27 - (3/4")	20	32	99	72	45	94
BF2110	Ø 34 - (1")	25	35	114	84	54	94
BF2112	Ø 42 - (1 1/4")	32	38	131	110	72	138
BF2115	Ø 48 - (1 1/2")	40	44	152	120	80	138
BF2120	Ø 60 - (2")	50	45	166	137	88	138

### Guide:

- 1.1 - Used for civil living and irrigation system.
- 1.2 - Avoid installing in high temperature locations.  
(Allowable temperature of 0° - 60°C).
- 1.3 - Avoid sticking the glue on valve ball.



## X. FEMALE THREADED PVC BALL VALVE - INOX HANDLE, PLASTIC BALL (BF-R)

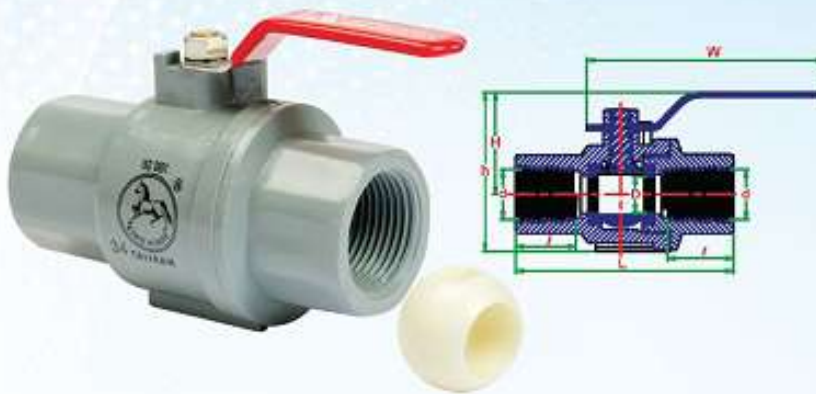

CODE	SPECIFICATIONS						
	SIZE	D	f	L	h	H	W
BF2104-R	Ø 21 - (PT1/2")	15	26	86	64.5	41	94
BF2106-R	Ø 27 - (PT3/4")	20	32	99	72	45	94
BF2110-R	Ø 34 - (PT1")	25	35	114	84	54	94
BF2112-R	Ø 42 - (PT1 1/4")	32	38	131	110	72	138
BF2115-R	Ø 49 - (PT1 1/2")	40	44	152	120	80	138
BF2120-R	Ø 60 - (PT2")	50	45	166	137	88	138

### Guide:

- 1.1 - Used for civil living and irrigation system.
- 1.2 - Avoid installing in high temperature locations.  
(Allowable temperature of 0° - 60°C).
- 1.3 - Avoid sticking the glue on valve ball.

## XI. PVC BALL VALVE - INOX HANDLE, INOX PLATED BALL (BX)

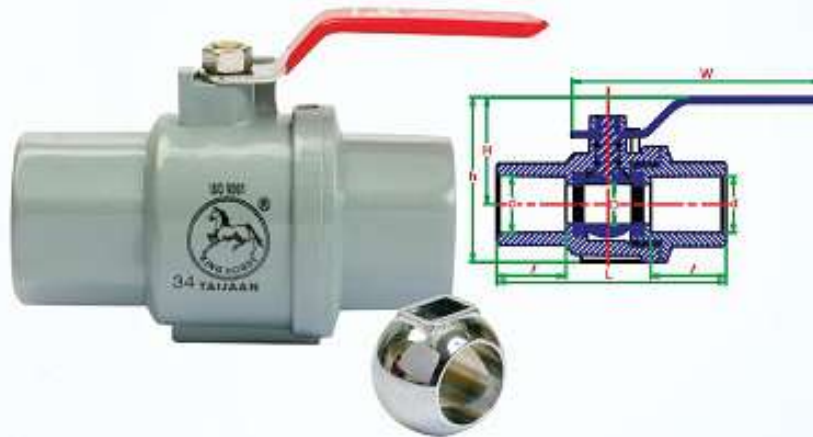

CODE	SPECIFICATIONS						
	SIZE	D	f	L	h	H	W
BX2104	Ø 21 - (1/2")	15	26	86	64.5	41	94
BX2106	Ø 27 - (3/4")	20	32	99	72	45	94
BX2110	Ø 34 - (1")	25	35	114	84	54	94
BX2112	Ø 42 - (1 1/4")	32	38	131	110	72	138
BX2115	Ø 49 - (1 1/2")	40	44	152	120	80	138
BX2120	Ø 60 - (2")	50	45	166	137	88	138
BX2130	Ø 90 - (3")	75	71	254	186	116	206

### Guide:

- 1.1 - Used for civil living and irrigation system.
- 1.2 - Avoid installing in high temperature locations.  
(Allowable temperature of 0° - 60°C).
- 1.3 - Avoid sticking the glue on valve ball.

## XII. FEMALE THREADED PVC BALL VALVE - INOX HANDLE, INOX PLATED BALL (BX-R)

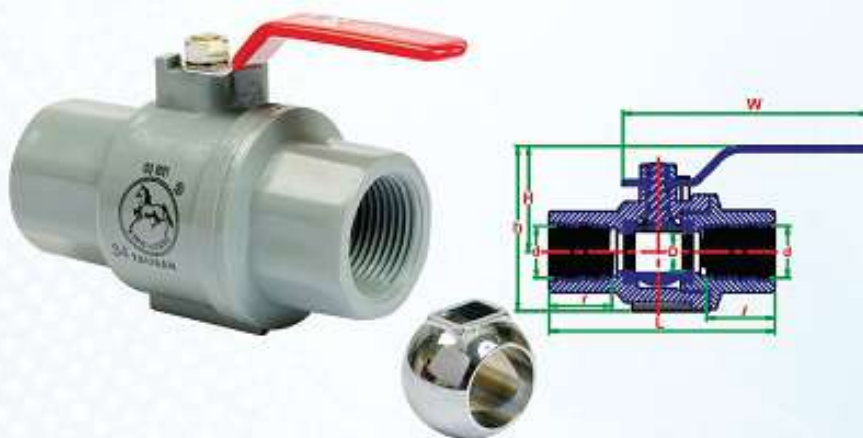

CODE	SPECIFICATIONS						
	SIZE	D	f	L	h	H	W
BX2104-R	Ø 21 - (PT1/2")	15	26	86	64.5	41	94
BX2106-R	Ø 27 - (PT3/4")	20	32	99	72	45	94
BX2110-R	Ø 34 - (PT1")	25	35	114	84	54	94
BX2112-R	Ø 42 - (PT1 1/4")	32	38	131	110	72	138
BX2115-R	Ø 49 - (PT1 1/2")	40	44	152	120	80	138
BX2120-R	Ø 60 - (PT2")	50	45	166	137	88	138

### Guide:

- 1.1 - Used for civil living and irrigation system.
- 1.2 - Avoid installing in high temperature locations.  
(Allowable temperature of 0° - 60°C).
- 1.3 - Avoid sticking the glue on valve ball.



### XIII. MALE THREADED PVC BALL VALVE - INOX HANDLE, INOX PLATED BALL (GX)

CODE	SPECIFICATIONS						
	SIZE	D	L	L	h	H	W
GX2104	Ø 21 - (1/2")	PT1/2" W14	28	98	64.5	41	94
GX2106	Ø 27 - (3/4")	PT3/4" W11	32	109	72	45	94
GX2110	Ø 34 - (1")	PT1" W11	35	124	84	54	94

#### Guide:

- 1.1 - Used for civil living and irrigation system.
- 1.2 - Avoid installing in high temperature locations.  
(Allowable temperature of 0° - 60°C).
- 1.3 - Avoid sticking the glue on valve ball.

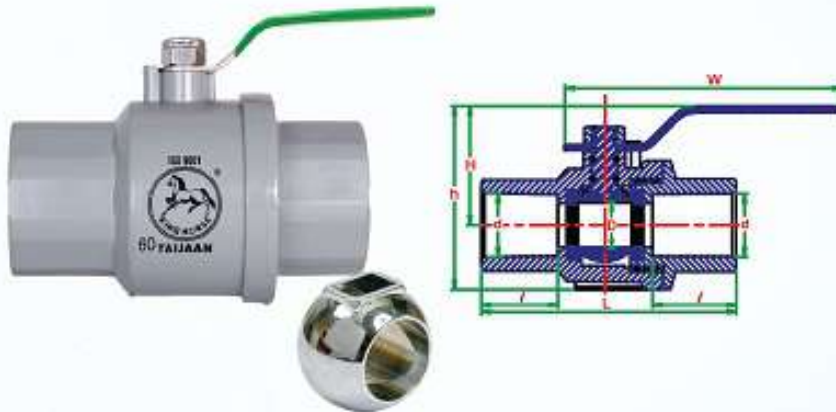

### XIV. PVC BALL VALVE - INOX HANDLE, INOX BALL (BI)

CODE	SPECIFICATIONS				
	SIZE	D	L	L	h
BI2204	Ø 21 - (1-2")	15	26	86	64.5
BI2206	Ø 27 - (3/4")	20	32	99	72
BI2210	Ø 34 - (1")	25	35	114	84
BI2212	Ø 42 - (1 1/4")	32	38	131	110
BI2215	Ø 49 - (1 1/2")	40	44	152	120
BI2220	Ø 60 - (2")	50	45	166	137
BI2230	Ø 90 - (3")	75	71	254	186

#### Guide:

- 1.1 - Used for civil living and irrigation system.
- 1.2 - Avoid installing in high temperature locations.  
(Allowable temperature of 0° - 60°C).
- 1.3 - Avoid sticking the glue on valve ball.

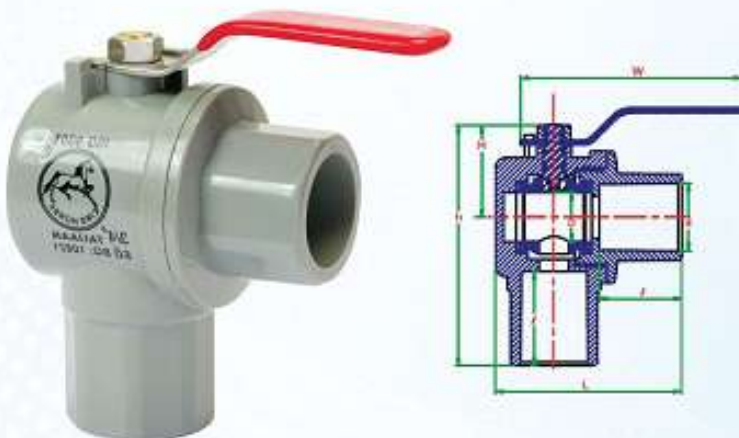

### XV. PVC ANGLE VALVE - INOX HANDLE (CX)

CODE	SPECIFICATIONS						
	SIZE	D	L	L	h	H	W
CX2104	Ø 21 - (1/2")	15	28	86	92	41	94
CX2106	Ø 27 - (3/4")	20	33	75	102	45	94

#### Guide:

- 1.1 - Used for civil living and irrigation system.
- 1.2 - Avoid installing in high temperature locations.  
(Allowable temperature of 0° - 60°C).
- 1.3 - Avoid sticking the glue on valve ball.



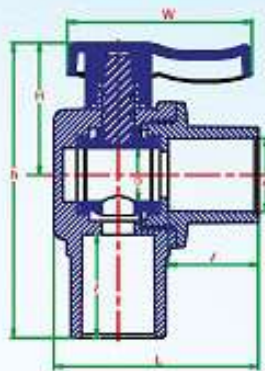

## XVI. PVC ANGLE VALVE - PLASTIC HANDLE (CK)

CODE	SPECIFICATIONS						
	SIZE	D	Z	L	h	B	W
CK1104	Ø 21 - (1/2")	15	28	66	93	44	68
CK1106	Ø 27 - (3/4")	20	33.5	75.5	107	49	68

### Guide:

- 1.1 - Used for civil living and irrigation system.
- 1.2 - Avoid installing in high temperature locations.  
(Allowable temperature of 0° - 60°C).
- 1.3 - Avoid sticking the glue on valve ball.



## XVII. CREPIN (E)

CODE	SPECIFICATIONS				
	SIZE	D	d	Z	H
E1106	Ø27 - (3/4")	55.5	27	35	153
E1110	Ø34 - (1")	55.5	34	41	160
E1112	Ø42 - (1 1/4")	55.5	42	41	160
E1115	Ø49 - (1 1/2")	79	49	64	220
E1120	Ø60 - (2")	79	60	64	220
E1125	Ø76 - (2 1/2")	130	76	67	250
E1130	Ø90 - (3")	141	90	77	275
E1140	Ø114 - (4")	215	114	93	352
E1150	Ø140 - (5")	256	140	100	430
ES1104	Ø21 - (1/2")	35.5	21	29	116
ES1106	Ø27 - (3/4")	35.5	27	29	116
ES1110	Ø34 - (1")	35.5	34	29	116

### Guide:

- 1.1 - Used to install in the pump cabin to suck water from wells, ponds, lakes, etc.

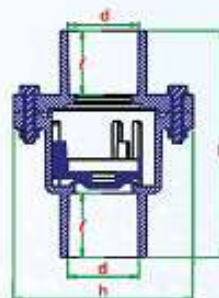

## XVIII. SCREWS CREPIN (I)

CODE	SPECIFICATIONS			
	SIZE	l	l <sub>1</sub>	h
I1106	Ø 27 - (3/4")	26	95	82
I1110	Ø 34 - (1")	30	104	82
I1112	Ø 42 - (1 1/4")	40	136	107
I1115	Ø 49 - (1 1/2")	43	145	117
I1120	Ø 60 - (2")	50	156	119
I1125	Ø 76 - (2 1/2")	57	212	150
I1130	Ø 90 - (3")	80	267	185
I1140	Ø 114 - (4")	90	315	215
I1150	Ø 140 - (5")	122	365	256

### Guide:

- 1.1 - Used to install directly into the mouth of the borehole.





## XIX. SCREWS CREPIN - DECREASE (I)

CODE	SPECIFICATIONS				
	SIZE	l1	l2	L	h
I1215	Ø42-Ø49 (1 1/4" - 1 1/2")	35	46	143	107
I1520	Ø49-Ø60 (1 1/2" - 2")	50	50	156	119

### Guide:

1.1 - Used to install directly into the mouth of the borehole.



## XX. ONE WAY CREPIN (D)

CODE	SPECIFICATIONS				
	SIZE	D	d	l	H
D1104	Ø 21 - (1/2")	52	21	28	93
D1106	Ø 27 - (3/4")	58	27	30	103
D1110	Ø 34 - (1")	68	34	38	131
D1112	Ø 42 - (1 1/4")	75	42	41	152
D1115	Ø 49 - (1 1/2")	90	49	48	167
D1120	Ø 60 - (2")	96	60	50	180
D1125	Ø 76 - (2 1/2")	130	76	67	221
D1130	Ø 90 - (3")	141	90	77	247

### Guide:

1.1 - Used to connect the pipes to transfer water to the high places that must use the bump to push water up, to keep the water from being lost during pumping up.

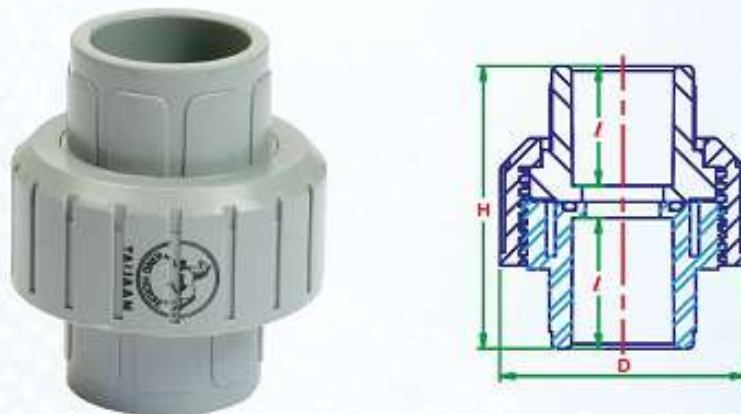

## XXI. PVC UNION/RACCORD (F)

CODE	SPECIFICATIONS			
	SIZE	D	l	H
F1104	Ø 21 - (1/2")	52	27	60
F1106	Ø 27 - (3/4")	57	28	62
F1110	Ø 34 - (1")	67	30	76
F1112	Ø 42 - (1 1/4")	75	37	83
F1115	Ø 49 - (1 1/2")	90	45	95
F1120	Ø 60 - (2")	96	47	102
F1125	Ø 76 - (2 1/2")	140	56.5	141
F1130	Ø 90 - (3")	157	60	155
F1140	Ø 114 - (4")	207	87	197

### Guide:

1.1 - Used to connect pipes in tight places, difficult to manage, cannot use rubber bands.  
 1.2 - Used in places where the piping is often required to be dismantled, like a water pump fitted with a plastic pipe.



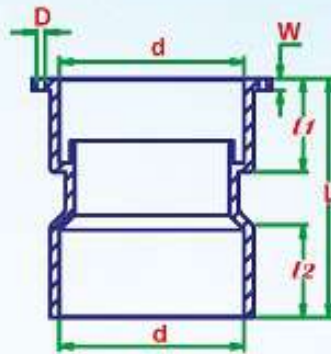

## XXII. PVC SLAB JOIN (JA)

CODE	SPECIFICATIONS					
	SIZE	D	W	l <sub>1</sub>	l <sub>2</sub>	L
JA15	Ø49 - (1 1/2")	4	4	45	45	115
JA20	Ø60 - (2")	4	5	45	45	115
JA20-L	Ø60 - (2")	4	5	55	130	220
JA30	Ø90 - (3")	4	5	45	45	115
JA40	Ø114 - (4")	4	5	45	45	115
JA40-L	Ø114 - (4")	4	5	55	130	220

### Guide:

- 1.1 - Used to connect lavabo drainage pipes, sewage pipes, toilet water through the floor (in the toilet).
- 1.2 - Used to connect drainage pipes from the roof to the floor (seno).

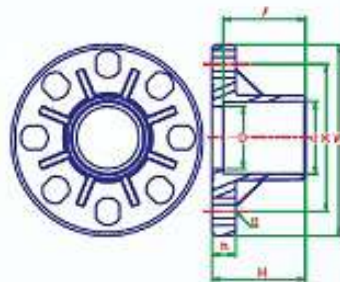

## XXIII. PVC FLANGE (HA)

CODE	Nominal diameter	SPECIFICATIONS						
		D	l	h	H	W	K	n
HA04	Ø21 1/2"	18	41	14	45	94	71	4
HA06	Ø27 3/4"	20	41	14	45	99	71	4
HA10	Ø34 1"	25	46	14	50	123	91	4
HA12	Ø42 1 1/4"	35	53	16	58	133	100	4
HA15	Ø49 1 1/2"	40	63	16	68	140	105	4
HA20	Ø60 2"	50	66	20	75	153	123	4
HA25	Ø76 2 1/2"	65	75	20	83	175	140	4
HA30	Ø90 3"	80	80	20	86	200	155	8
HA40	Ø114 4"	103	95	20	107	210	178	8
HA50	Ø140 5"	127	112	21	120	250	215	8
HA60	Ø168 6"	144	128	21	140	278	240	8

### Guide:

- 1.1 - Used to connect pipeline and water lock valve for high pressure pipelines.



## XXIV. PVC BLIND FLANGE (HB)

CODE	Nominal diameter	SPECIFICATIONS			
		h	W	K	n
HB04	Ø21 1/2"	14	94	71	4
HB06	Ø27 3/4"	14	99	71	4
HB10	Ø34 1"	14	123	91	4
HB12	Ø42 1 1/4"	16	133	100	4
HB15	Ø49 1 1/2"	16	140	105	4
HB20	Ø60 2"	20	153	123	4
HB25	Ø76 2 1/2"	20	175	140	4
HB30	Ø90 3"	20	200	155	8
HB40	Ø114 4"	20	210	178	8
HB50	Ø140 5"	21	250	215	8
HB60	Ø168 6"	21	278	240	8

### Guide:

- 1.1 - Used to block off a section of pipeline system using flange.



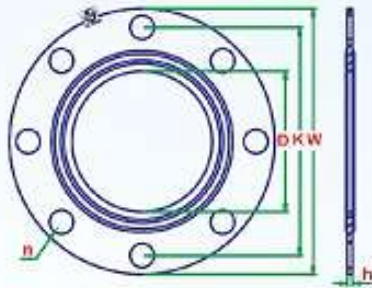

## XXV. GASKET FLANGE (HD)

CODE	SPECIFICATIONS					
	SIZE	D	h	W	K	n
HD04	Ø21 (1/2")	18	3.8	94	71	4
HD06	Ø27 (3/4")	20	3.8	99	71	4
HD10	Ø34 (1")	25	4	123	91	4
HD12	Ø42 (1 1/4")	35	4	133	100	4
HD15	Ø49 (1 1/2")	40	4	140	105	4
HD20	Ø60 (2")	50	4	153	123	4
HD25	Ø76 (2 1/2")	65	4	175	140	4
HD30	Ø90 (3")	80	4	200	155	8
HD40	Ø114 (4")	103	5	210	178	8
HD50	Ø140 (5")	127	5	250	215	8
HD60	Ø168 (6")	144	5	278	240	8

### Guide:

1.1 - Used to buffer between two flange ends for water leakage protection purposes.

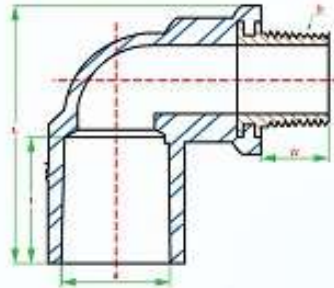

## XXVI. BRASS MALE ELBOW, REDUCING BRASS MALE ELBOW (KL21)

CODE	SPECIFICATIONS				
	SIZE	D	L	f1	l
KL210404	Ø 21 - (1/2")	PT1/2" W14	60	14.5	30
KL210606	Ø 27 - (3/4")	PT3/4" W14	72	17	35
KL210604	Ø27 - Ø21 (3/4"-1/2")	PT1/2" W14	72	14.5	35

### Guide:

1.1 - Used for civil living and irrigation system.

1.2 - Avoid installing in high temperature locations. (Allowable temperature of 0° - 60°C).

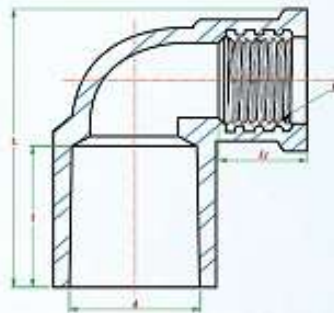

## XXVII. BRASS FEMALE ELBOW, REDUCING BRASS FEMALE ELBOW (KL22)

CODE	SPECIFICATIONS				
	SIZE	D	L	f1	l
KL220404	Ø 21 - (1/2")	PT1/2" W14	60	17	30
KL220606	Ø 27 - (3/4")	PT3/4" W14	72	17	35
KL220604	Ø27 - Ø21 (3/4"-1/2")	PT1/2" W14	72	17	35

### Guide:

1.1 - Used for civil living and irrigation system.

1.2 - Avoid installing in high temperature locations. (Allowable temperature of 0° - 60°C).



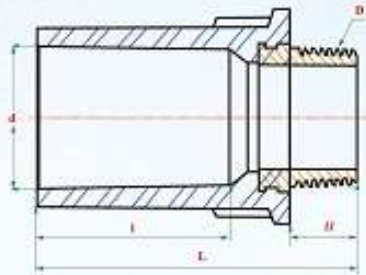

### XXVIII. BRASS MALE ADAPTER/SOCKET, REDUCING BRASS MALE ADAPTER/SOCKET (KS21)

CODE	SPECIFICATIONS				
	SIZE	D	L	l	H
KS210404	Ø 21 - (1/2")	PT1/2" W14	68	14.5	30
KS210606	Ø 27 - (3/4")	PT3/4" W14	73.5	17	35
KS210604	Ø27 - Ø21 (3/4"-1/2")	PT1/2" W14	73.5	14.5	35

**Guide:**

- 1.1 - Used for civil living and irrigation system.
- 1.2 - Avoid installing in high temperature locations. (Allowable temperature of 0° - 60°C).

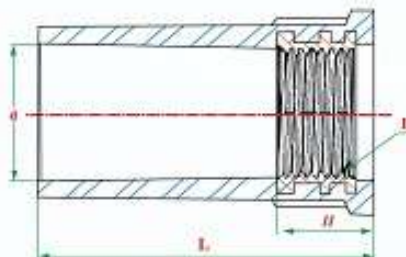

### XXIX. BRASS FEMALE ADAPTER/SOCKET, REDUCING BRASS FEMALE ADAPTER/SOCKET (KS22)

CODE	SPECIFICATIONS			
	SIZE	D	L	l
KS220404	Ø 21 - (1/2")	PT1/2" W14	52	17
KS220606	Ø 27 - (3/4")	PT3/4" W14	59	19
KS220604	Ø27 - Ø21 (3/4"-1/2")	PT1/2" W14	59	17

**Guide:**

- 1.1 - Used for civil living and irrigation system.
- 1.2 - Avoid installing in high temperature locations. (Allowable temperature of 0° - 60°C).

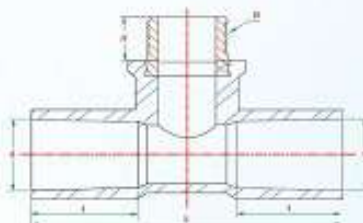

### XXX. BRASS MALE TEE, REDUCING BRASS MALE TEE (KT21)

CODE	SPECIFICATIONS				
	SIZE	D	L	l1	l2
KT210404	Ø 21 - (1/2")	PT1/2" W14	86	15	30
KT210606	Ø 27 - (3/4")	PT3/4" W14	102	17	35
KT210604	Ø27 - Ø21 (3/4"-1/2")	PT1/2" W14	102	15	35

**Guide:**

- 1.1 - Used for civil living and irrigation system.
- 1.2 - Avoid installing in high temperature locations. (Allowable temperature of 0° - 60°C).



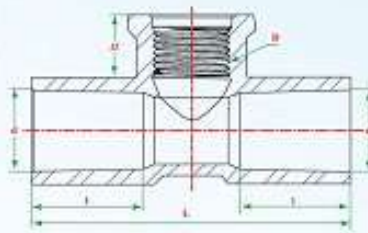

### XXXI. BRASS FEMALE TEE, REDUCING BRASS FEMALE TEE (KT22)

CODE	SPECIFICATIONS				
	SIZE	D	L	I1	I
KT220404	Ø 21 - (1/2")	PT1/2" W14	86	15	30
KT220606	Ø 27 - (3/4")	PT3/4" W14	102	17	35
KT220604	Ø27 - Ø21 (3/4"-1/2")	PT1/2" W14	102	15	35

#### Guide:

- 1.1 - Used for civil living and irrigation system.
- 1.2 - Avoid installing in high temperature locations. (Allowable temperature of 0° - 60°C).

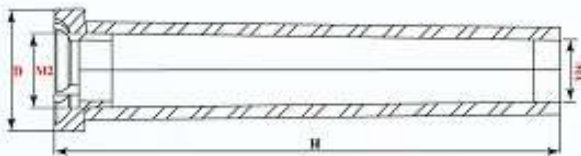

### XXXII. UNIVERSAL ASSEMBLY/DISASSEMBLY TOOLS

CODE	SPECIFICATIONS				
	SIZE	D	H	M1	M2
NA001		44	185	23	27

#### Guide:

- 1.1 - Universal adapter is used to assemble/disassemble 4-slotted nuts, hexagonal nut size 27, hexagonal nut size 23 in water cocks and toilet supplies.

### XXXIII. OTHERS

With 16 years of experience in mold making, manufacturing and production of various plastic products, Tai Jaan has successfully trained and developed extensively experienced and highly skillful engineers and workers to be able to cover the concept, 3D mold, mold making and supplying. Moreover, fabrication and mass production are supported by international standardized pellet materials source, Tai Jaan can process and produce a wide range of products for customers after designing and manufacturing molds as required.





Being aware of production & business system significance embodied in its outstanding development visions, premium quality and high prestige are used as the Company's reliable background. Since its inception, Tai Jaan has successfully designed and developed the ISO 9001 standard management system and production & business procedure. Tai Jaan was issued with ISO 9001:2000 Certificate in 2007. Up to now, our system has been always maintained, updated and qualified in ISO Standards from time to time. Currently, it is ISO 9001:2015 Standard Certificate.







## **TAI JAAN PLASTIC (VIET NAM) LIMITED LIABILITY COMPANY**

### **HEAD OFFICE**

Address: Lot M-1A-CN, Road D9, My Phuoc Industrial Park, Thoi Hoa Ward, Ben Cat Town,  
Binh Duong Province, Viet Nam

Tel: (+84) 274.3567.222/223/224

Fax: (+84) 274.3567.225

Email: [taijaan.plastic@gmail.com](mailto:taijaan.plastic@gmail.com)

Website: [taijaanplastic-vn.com](http://taijaanplastic-vn.com)

### **BRANCH**

Address: An Chieu 2 Hamlet, Lien Phuong Commune, Hung Yen City,  
Hung Yen Province, Viet Nam

Tel: (+84) 321.3511.088

Fax: (+84) 321.3511.089

Email: [taijaan.plastic@gmail.com](mailto:taijaan.plastic@gmail.com)

